

General Features Descriptions

The **Content Pane** includes the name of the Data Center, Topics, Indicators, Group/Category, Basemaps and Optional Layers, Layer Controls. Clicking the **i** button at the top provides a more comprehensive definition of the active data center.

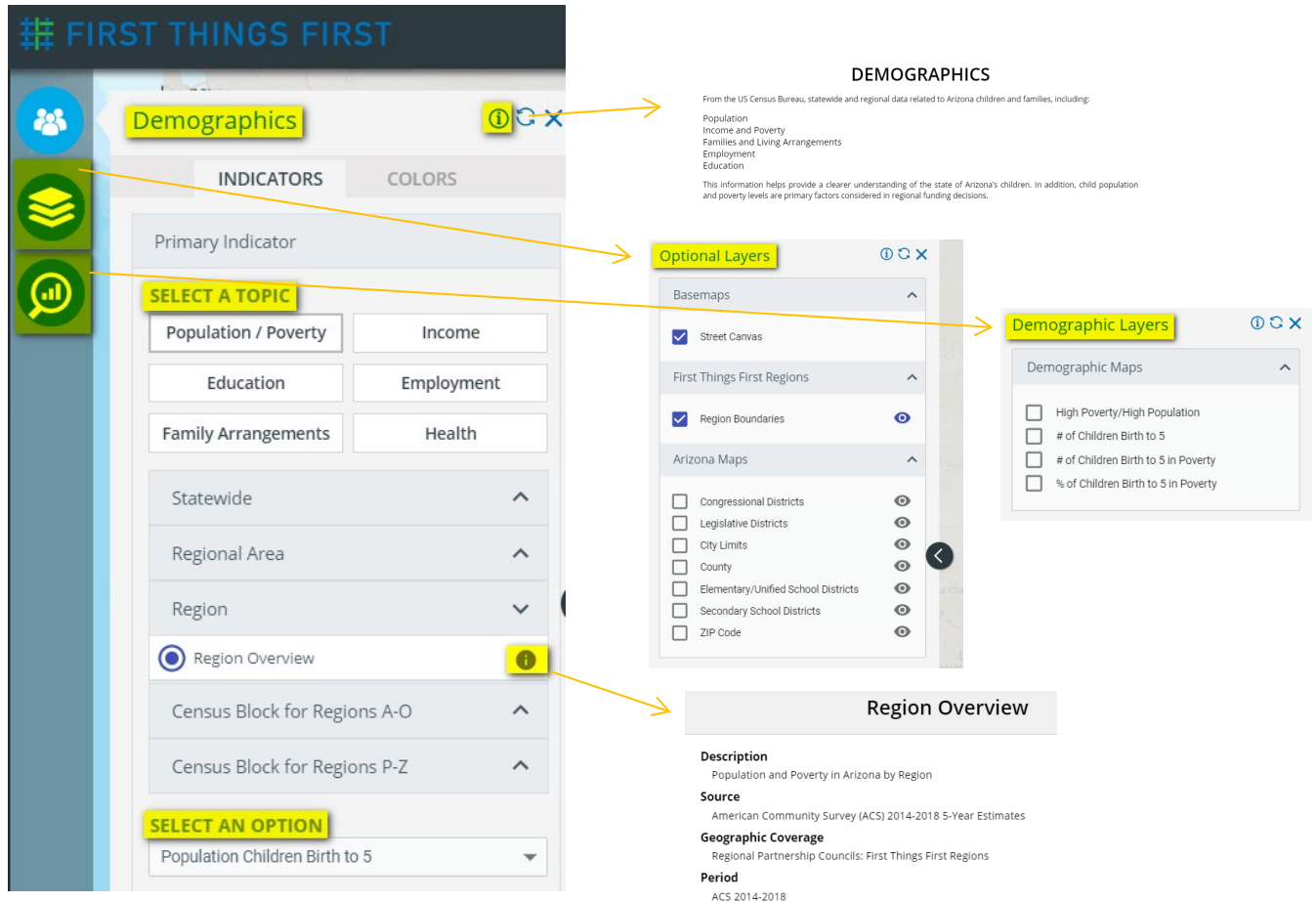

Generating a map in 3 steps:

1. Select a **Topic** (button)
2. Select an **Indicator** (radio button)
3. Select an **Option** (dropdown)
4. **Active indicator overlay** is how the map shades or plots licensed providers depending on what indicator is selected in the 2nd selection.
5. **Active geography** - rolling your mouse (hovering) over the map will outline the geography in **yellow**.

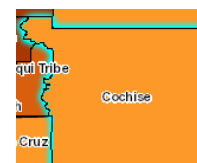
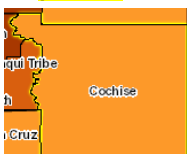

Clicking/selecting the geography will change the outline color from yellow to **teal**.

Guides & Tutorials

- 6. **Tooltip text box** – Rolling the mouse over geography (region, census block, or licensed provider) will bring a corresponding Tooltip text box that displays in the upper-left hand corner with the title of the geography and related indicator data.

Cochise	
Total Population	127,459
Population Children Birth to 5	9,239
Total Population	127,459
% Population of Children Birth to 5	7 %

Note: Once geography is selected (outlined in teal), the tooltip text box will display the same data values regardless what geography you hover over until the geography is unselected. To unselect, click the active geography one time. Once the hover over color is yellow, the Tooltip text box data will update to the corresponding

- 7. **Map, Table, Bar, Trend tabs**



Clicking the **Data & Analysis** button brings up the **Table**, **Trends** and **Bar Chart** tabs allows the user to switch views between the mapped representation of the selected indicator data set and a tabular view that can be sorted by headings.

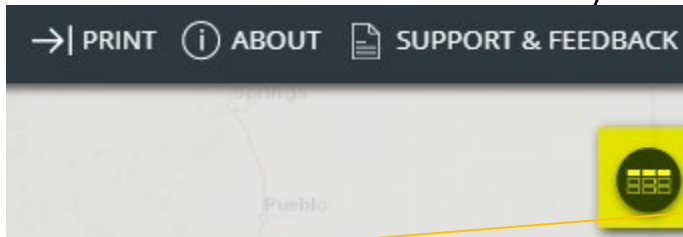

Data & Analysis

REGION	CAPACITY BUILDING	2012	2013	2014	2015	2016	2017	2018	2019	2020	2021
Cochise	\$ Allotted	NULL	NULL	NULL	NULL	NULL	NULL	NULL	NULL	NULL	NULL
Cocopah	\$ Allotted	NULL	NULL	NULL	NULL	NULL	NULL	NULL	NULL	NULL	NULL
Cocopah Tribe	\$ Allotted	NULL	NULL	NULL	NULL	NULL	NULL	NULL	NULL	NULL	NULL
Colorado River Indian Tribes	\$ Allotted	NULL	NULL	NULL	NULL	NULL	NULL	NULL	NULL	\$ 15,000	NULL
East Maricopa	\$ Allotted	NULL	NULL	NULL	NULL	NULL	NULL	NULL	NULL	NULL	NULL
Gila	\$ Allotted	NULL	NULL	NULL	NULL	NULL	NULL	NULL	NULL	NULL	NULL
Gila River Indian Community	\$ Allotted	NULL	NULL	NULL	NULL	NULL	NULL	NULL	NULL	NULL	NULL
Graham/Greenlee	\$ Allotted	NULL	NULL	NULL	NULL	NULL	NULL	NULL	NULL	NULL	NULL
Hualapai Tribe	\$ Allotted	NULL	NULL	NULL	NULL	NULL	NULL	NULL	NULL	NULL	NULL
Navajo Nation	\$ Allotted	NULL	NULL	NULL	NULL	NULL	NULL	NULL	NULL	NULL	NULL
La Paz/Mohave	\$ Allotted	NULL	NULL	NULL	NULL	NULL	NULL	NULL	NULL	NULL	NULL
Navajo/Apache	\$ Allotted	\$ 50,000	NULL	NULL	NULL	NULL	NULL	NULL	NULL	NULL	NULL
Northwest Maricopa	\$ Allotted	NULL	NULL	NULL	NULL	NULL	NULL	NULL	NULL	NULL	NULL
Pasqua Yaqui Tribe	\$ Allotted	NULL	NULL	NULL	NULL	NULL	NULL	NULL	NULL	NULL	\$ 60,000
Phoenix North	\$ Allotted	NULL	NULL	NULL	NULL	NULL	NULL	NULL	NULL	NULL	\$ 50,000
Phoenix South	\$ Allotted	NULL	NULL	NULL	NULL	NULL	NULL	\$ 0	NULL	\$ 100,000	\$ 125,000
Pima North	\$ Allotted	NULL	NULL	NULL	\$ 0	NULL	NULL	NULL	NULL	NULL	NULL
Pima South	\$ Allotted	NULL	NULL	NULL	\$ 0	NULL	NULL	NULL	NULL	NULL	NULL
Pinal	\$ Allotted	NULL	NULL	NULL	NULL	NULL	NULL	NULL	NULL	NULL	NULL
San River Pima-Maricopa Indian Community	\$ Allotted	NULL	NULL	NULL	NULL	NULL	NULL	NULL	NULL	NULL	NULL
San Carlos Apache	\$ Allotted	NULL	NULL	NULL	NULL	NULL	NULL	NULL	NULL	NULL	NULL
Santa Cruz	\$ Allotted	NULL	NULL	NULL	NULL	NULL	NULL	NULL	NULL	NULL	\$ 10,000
Southeast Maricopa	\$ Allotted	NULL	NULL	NULL	NULL	NULL	NULL	NULL	NULL	NULL	NULL

Guides & Tutorials

The **Table** tab has all available fields for the selected indicator however only the “checked” box fields will appear in the table. Use the checkboxes to include or exclude fields.

Select Table Columns

<input type="checkbox"/> RPCID	<input type="checkbox"/> Regional Area - Region	<input checked="" type="checkbox"/> Region	<input checked="" type="checkbox"/> Capacity Building	<input type="checkbox"/> Trend	<input type="checkbox"/> Benchmark
<input checked="" type="checkbox"/> 2012	<input checked="" type="checkbox"/> 2013	<input checked="" type="checkbox"/> 2014	<input checked="" type="checkbox"/> 2015	<input checked="" type="checkbox"/> 2016	<input checked="" type="checkbox"/> 2017
<input checked="" type="checkbox"/> 2018	<input checked="" type="checkbox"/> 2019	<input checked="" type="checkbox"/> 2020	<input checked="" type="checkbox"/> 2021		

Use the **Export** button to create a CSV file containing the data which can be opened in Excel.

REGION	POPULATION CHILDREN BIRTH TO 5	TOTAL POPULATION	% POPULATION OF CHILDREN BIRTH TO 5	POVERTY CHILDREN BIRTH TO 5	TOTAL POVERTY	% POVERTY CHILDREN BIRTH TO 5	RANGE % POVERTY CHILDREN BIRTH TO 5	FAMILIES WITH CHILDREN UNDER 5 YEARS	BELOW 100% POVERTY	B
Cochise	9,239					28%	21-30%	5,620	27%	3
Coconino	8,693					27%	21-30%	4,648	22%	2
Cocopah Tribe	91					55%	40-100%	48	53%	6
Colorado River Indian Tribes	767	8,292	9%	373	2,297	49%	40-100%	531	45%	5
East Maricopa	54,210	896,243	6%	7,712	93,007	14%	11-20%	31,309	14%	1
Gila	2,438	45,016	5%	862	7,591	35%	31-40%	1,326	31%	3
Gila River Indian Community	1,054	12,148	9%	688	5,694	65%	40-100%	368	59%	7
Graham/Greenlee	3,642	42,427	9%	876	6,133	24%	21-30%	1,905	20%	2
Hualapai Tribe	132	1,425	9%	62	484	47%	40-100%	87	38%	4
Navajo Nation	9,535	101,802	9%	4,829	40,862	51%	40-100%	4,242	49%	6
La Paz/Mohave	11,049	215,104	5%	3,298	38,162	30%	21-30%	6,267	23%	3
Navajo/Apache	5,206	72,236	7%	1,517	12,470	29%	21-30%	2,820	28%	3

The **Bar** tab view contains a scrollable bar chart of the selected indicator. The data can be sorted by geography or numeric value by using the Sort By: dropdown menu. Sort the data by ascending or descending order.

Sort By: Area Name | ASCENDING

Region	Value
Cochise	9,239
Coconino	8,693
Cocopah Tribe	91
Colorado River Indian Tribes	767
East Maricopa	54,210
Gila	2,438
Gila River Indian Community	1,054
Graham/Greenlee	3,642
Hualapai Tribe	132
La Paz/Mohave	11,049

Guides & Tutorials

The **Trend** tab view shows trends over time, where appropriate. Not all indicators have a Trend feature. Use the checkboxes to include or exclude a Region from the trend graph. Regions will automatically be checked if they have an indicator value..

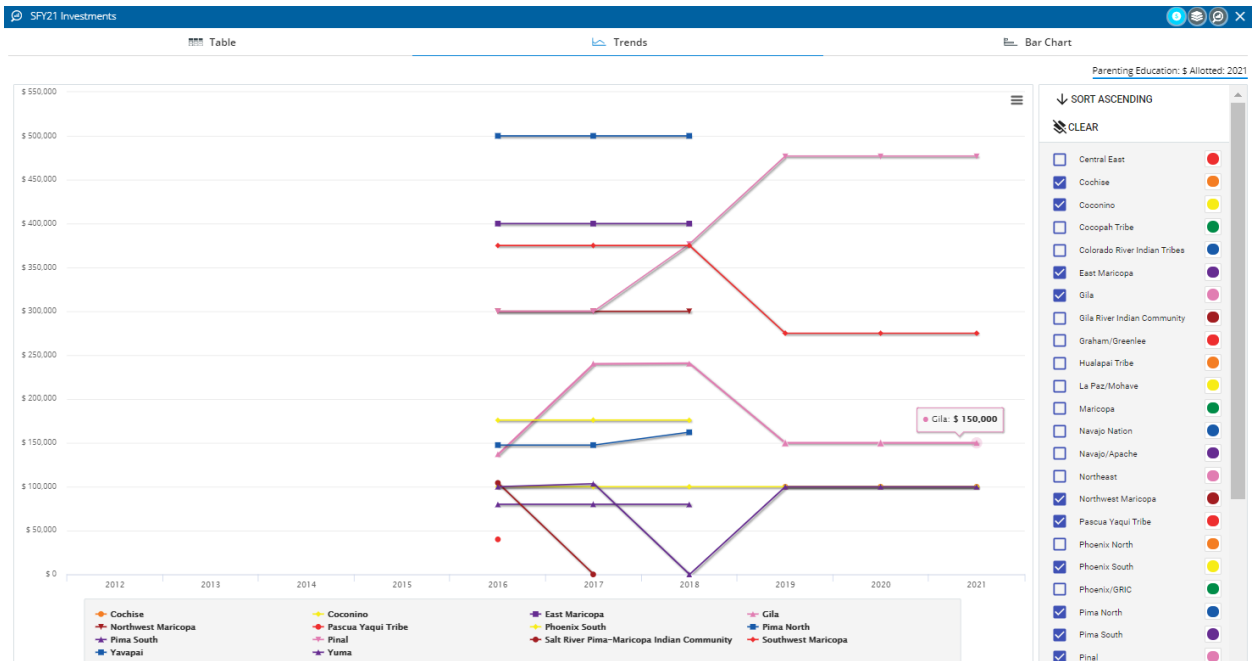

8. **Map label** shows under the map and displays the active indicator. Map labels can also be found within the Table, Bar and Trend tabs.

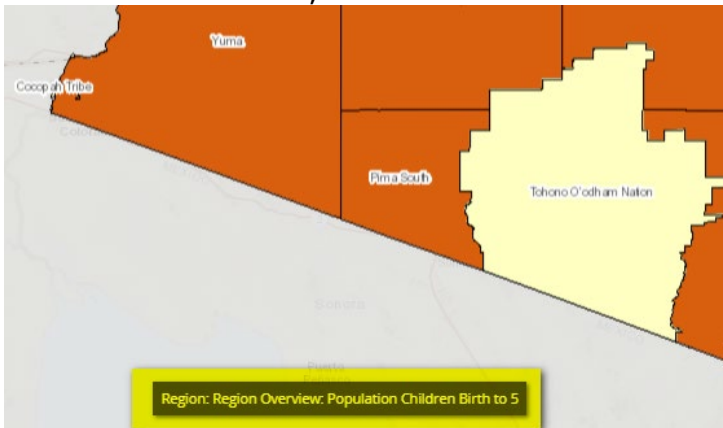

9. **Legend** - The basic Map view includes a detailed legend and thematic controls. Use the tools to change the color palette for the map area or the distribution (quantile vs. equal interval vs natural breaks).